

V8

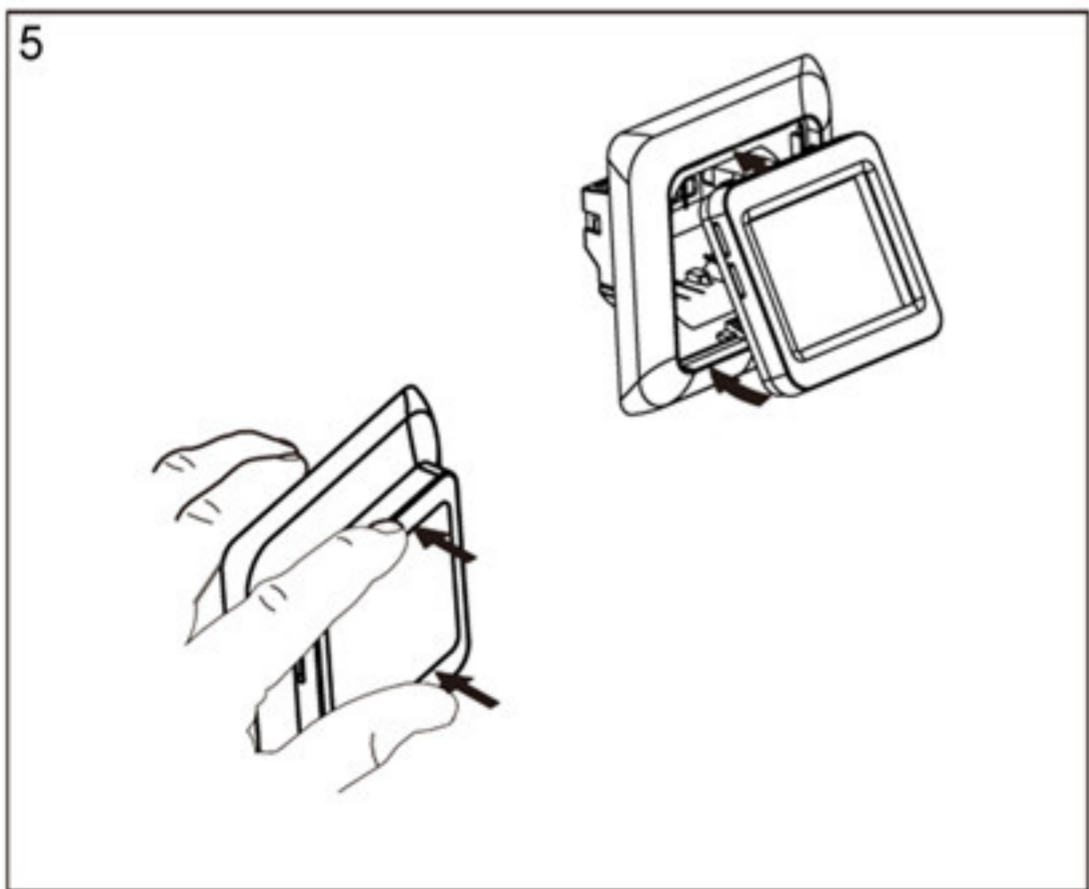

- English

ILLUSTRATIONS

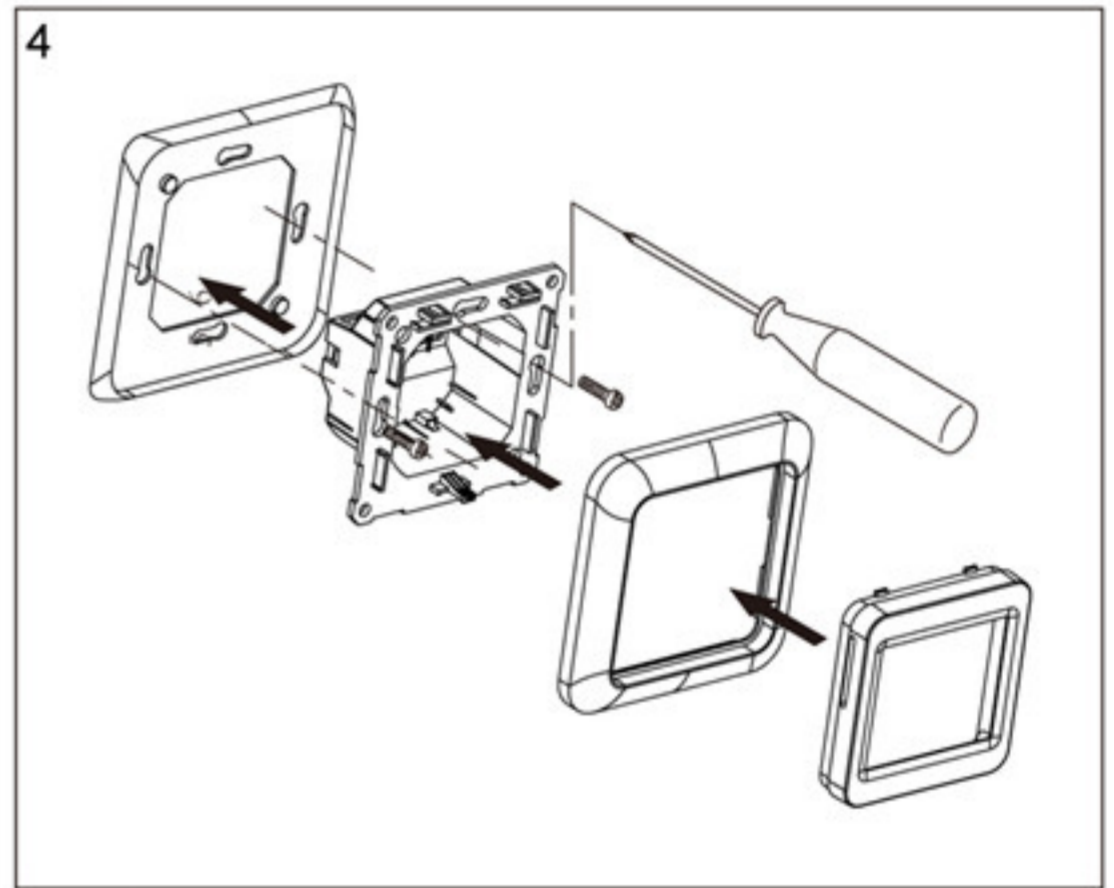
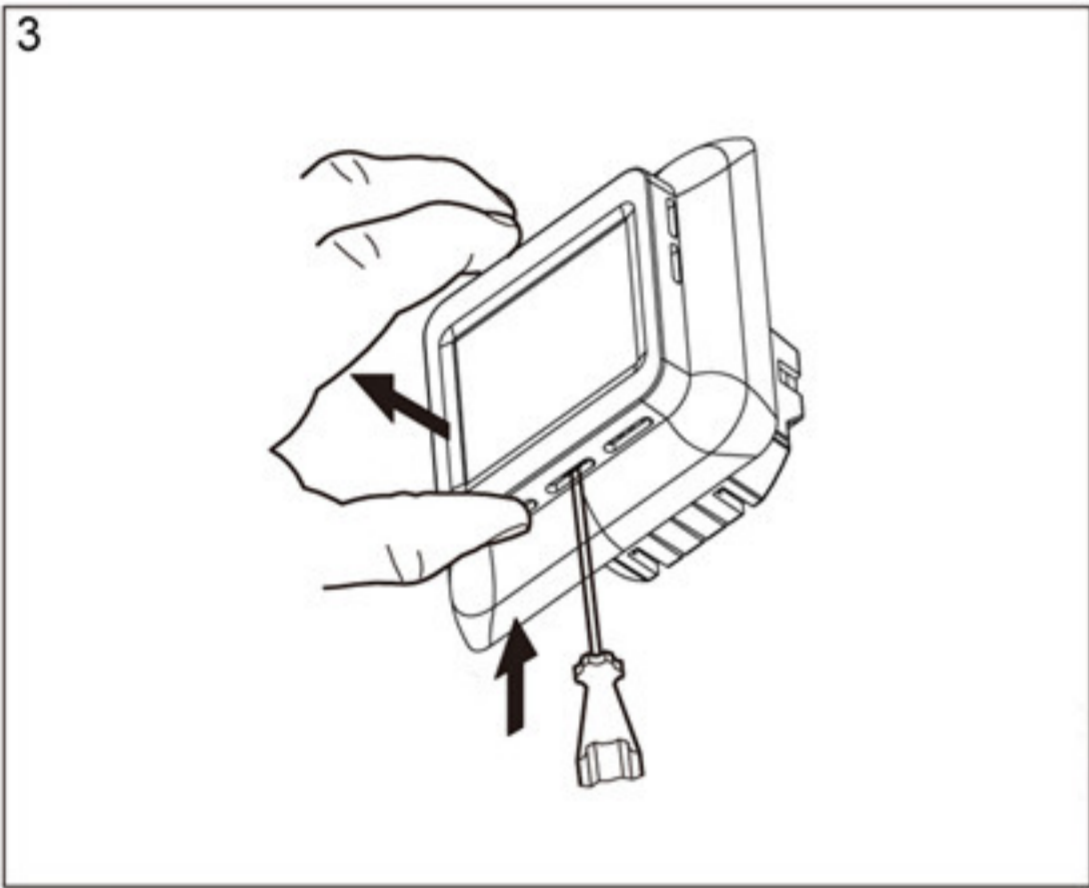
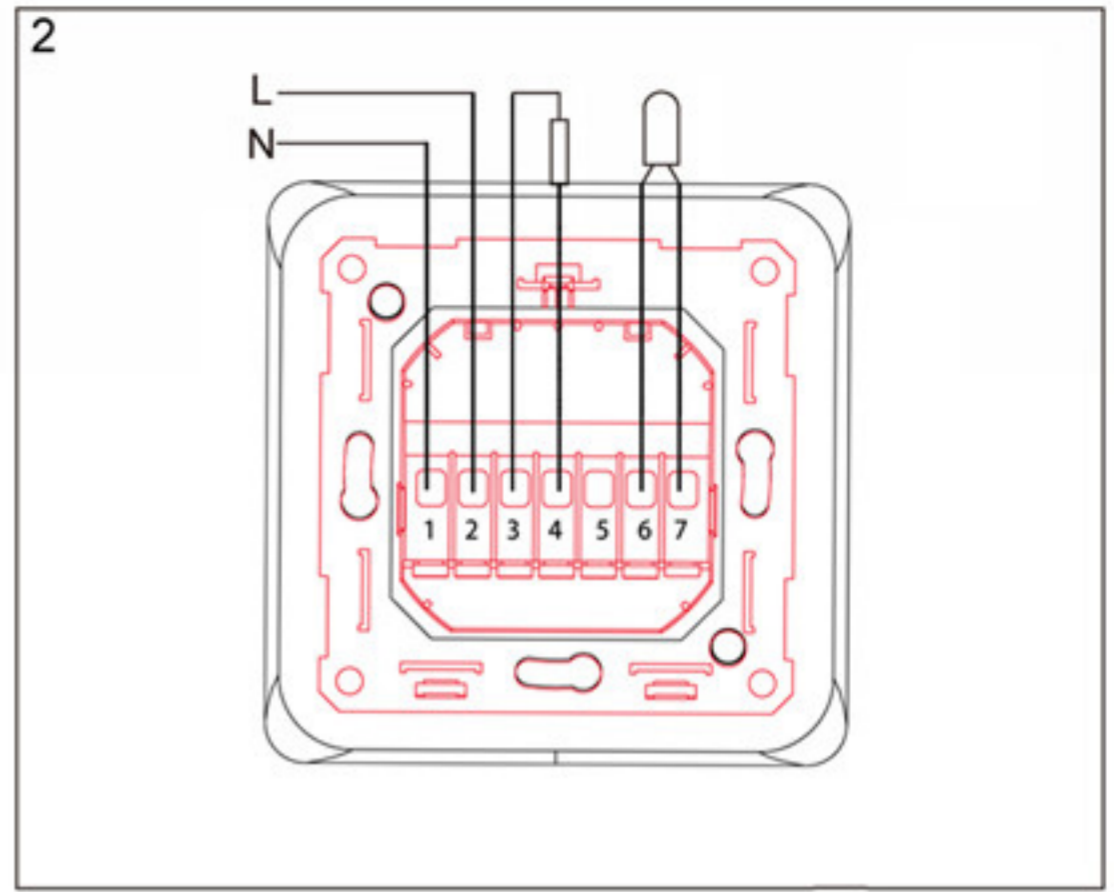
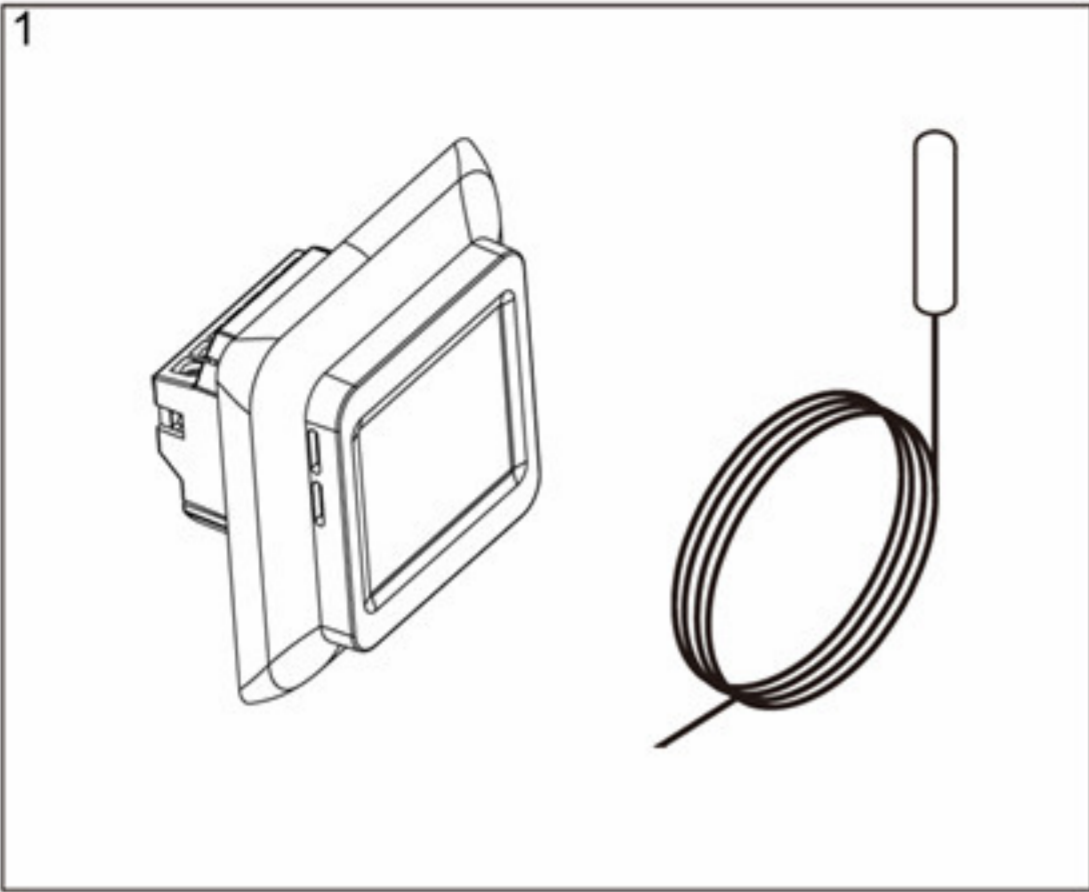

V8 - WARNING – Important Safety Instructions

Disconnect the power supply before carrying out any installation or maintenance work on this thermostat and associated components. The thermostat and associated components should only be installed by a competent person (i.e. a qualified electrician). Electrical installation must be in accordance with appropriate statutory regulations.

V8 Electrical Heating Thermostat

Touch Screen Period Programming Thermostat Weekly circulation, it is possible to set 6 periods called events each day with corresponding pre-set temperatures, also you can select "period control mode" or "manual mode" according to your individual requirements. The thermostat is recommended for the control of electric heating devices or on/off valve actuator used in water-based heating systems.



Technical data:

Voltage:	AC230V 50~60Hz
I _{max} :	16A
Power consumption:	2VA
Setting range:	5°C...95°C
Limitation range:	5°C...60°C (factory setting:35°C)
Accuracy of temperature measurement:	0.5~10°C Adjustable, factory setting±1°C
Ambient temperature:	-5~50°C
Protective housing:	IP20
Housing material:	anti-flammable PC

User operation



1) Power key "  "

You can turn on/off the thermostat by pressing this key. Also you can confirm and exit by pressing "  "key when you have completed the setting of every parameter.

2) The increase key"  "and the decrease key"  "

In the period control mode or comfort mode , when you press the increase/decrease key once, alternate display stops in the bottom right region and the value of the pre-set temperature will increase/decrease 1°C. It will recover the alternate display with no operation for 3 seconds.

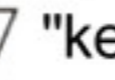

3) Time setting key "  "

You can adjust the time and week by pressing the key once. If it is pressed, the hour bit flashes. Then you can press "  " key and "  "key to change its value. When you complete the setting of hour bit, you can press this key to confirm and continue the setting of minute bit and week bit sequentially. After the completion of time, you can press"  "to confirm and exit.









4) Mode selection key"  "

You can select period control mode or comfort mode by pressing the key. If you press this key and hold for 3 seconds, you can enter the mode of period programming.

5) Locking "  " and unlocking

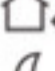
When you press "  "and"  "at the same time and hold for 3 seconds, the thermostat will be locked/unlocked. When it is locked, no operation can be carried out until it is unlocked.

Display symbols:

	Manual mode
	Clock-controlled program mode
	Wake-up, event 1
	Leave (am), event 2
	Return (am), event 3
	Leave (pm), event 4
	Return (pm), event 5
	Sleep, event 6
	Heating on

Programming: 6-event time and temperature

Press the "📖" key for 5 seconds to begin programming

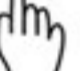
Key	Event	Symbol	Time	▲ ▼	Default value	▲ ▼
	Day 1-5	1	06:00	Set the start/end	20°C	Set programmed
		2	08:00		15°C	
		3	11:30		15°C	
		4	12:30		15°C	
	Day 6-7	5	17:00		22°C	
		6	22:00		15°C	
		1	08:00		22°C	
		2	23:00		15°C	

Advanced setting (qualified person preferred)

You can press "📖" and "🕒" and hold for 5 seconds at the same time to enter the mode of advanced setting when the thermostat is turned off. The following seven function can be chosen by pressing "📖".

Symbol	Setting	▲or ▼
1 ADJ	Temperature calibration	Adjust measured temperature
2 SEN	Sensor mode	IN: built-in sensor OUT: floor sensor ALL: both sensors (floor sensor is the limit sensor)
3 LIT	Limitation temperature	Adjust limitation value, Limitation range: 5~60°C
4 DIF	Switching differential	Adjust switching differential
5 LTP	Antifreeze function	Turn on/off Anti-frozen function
6 PRG	Set vacation mode	2: 5/2 day mode 1: 6/1 day mode 0: 7 day mode
7 RLE	Potential-free output	00: in same way 01: in different way
8 DLY	Potential-free output delay	Change the delay time
9 HIT	Max. Temperature	Max. Limitation temperature setpoint (35~95°C)
AFAC	Reset to factory settings	Programming parameters will be reset to factory settings when symbol "- -" appears

Explanation of symbols

